

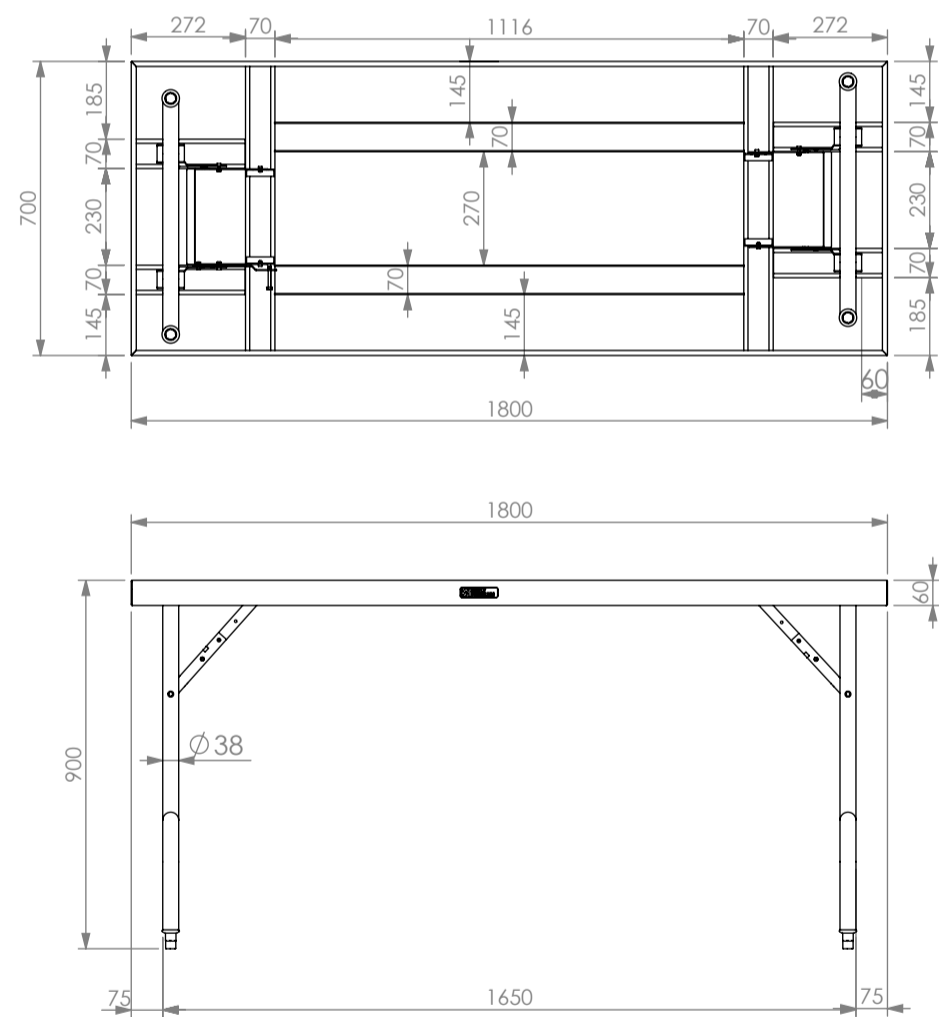

SPECIFICATION	
Tops	<ul style="list-style-type: none"> - High quality stainless steel. - 1.2mm gauge, no. 4 Finish.
Core	<ul style="list-style-type: none"> - 3mm zincalume. - Top hat stiffening. - Marine grade protective paint .
Frames	<ul style="list-style-type: none"> - Ø38mm round stainless steel tube. - Satin polished. - Machined collars. - Adjustable stainless disc feet disc bullet feet. - Heavy duty hinge.



38	Folding Events Table			
	Product Code	Dimensions (mm)	Unit weight (Kg)	Load capacity (Kg)
	38-ET	1800x700x900	31.27	160